

applications

determination of load-bearing capacity and compaction quality of soils and aggregates

- ✓ subgrade
- ✓ railway construction
- ✓ trenches and canal construction
- ✓ pipeline construction
- ✓ backfill for bridges
- ✓ fast and safe self-supervision
- ✓ clear data reports for the client

ZFG 3000 GPS



- ✓ device operated by one person
- ✓ no counterweight required
- ✓ easy menu guidance
- ✓ suitable for use inside small trenches
- ✓ immediate display of deformation modulus (Evd)
- ✓ s/v ratio for assessment of soil compactibility
- ✓ premium LCD display
- ✓ high capacity accumulator with speedcharger
- ✓ GPS coordinates in UTM and Gauss-Krueger format
- ✓ splash-proof electronic box

including

- ✓ ZORN software for data analysis and editing of test reports, create your individual user profile, connect your GPS data with Google Maps
- ✓ SD-card for data transfer to PC
- ✓ 300 mm loading plate with 10 kg loading device, Evd measuring range 15-70 MN/m², maximum measuring depth 600 mm
- ✓ Thermal printer for on-site editing of test reports including deflection graph

test procedure

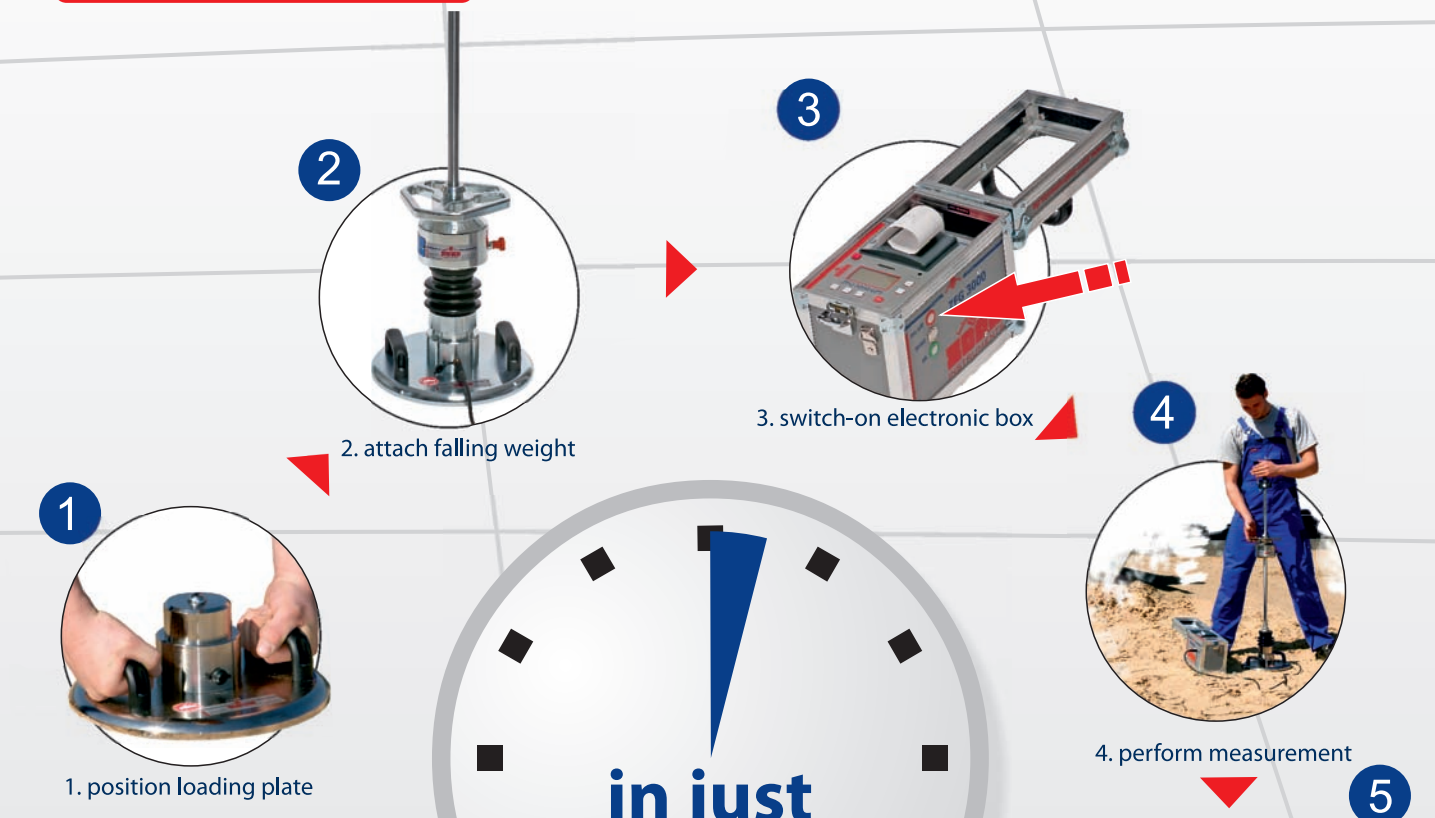

PC software

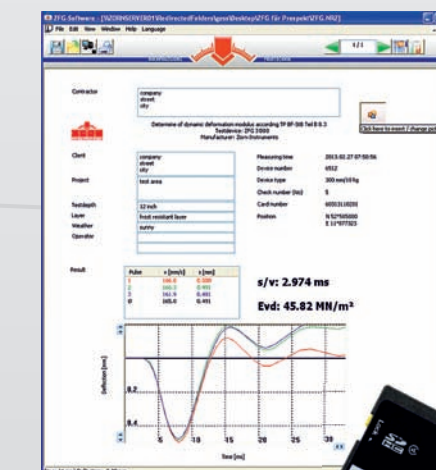

SD-card

- SD drive safely integrated in electronic box
- fast and simple data transfer

**fast
easy
reliable**

test standards and regulations

current industry standards (abstract) for the dynamic plate load test

ASTM E2835-11 (North America)
TP BF-StB Part B 8.3 and ZTVE-StB 09 (Germany)
RiL-DB 836 (Deutsche Bahn, Germany)

RVS 08.03.04 März 2008 (Austria)
KMF (Aargau, Switzerland)

HOCHPRÄZISIONS PRÜFTECHNIK

ZORN
INSTRUMENTS

zorn-instruments.com



ZORN INSTRUMENTS e.K. • Benzstraße 1 • 39576 Stendal (Germany)

Tel.: +49 39 31- 2 52 73 0

Fax: +49 39 31- 2 52 73 10

www.zorn-instruments.com

info@zorn-instruments.com